









# EL-USB-1 Manual

## LED FLASHING MODES



Red/Green LED

Orange LED

-  **Green double flash**  
The data logger is not currently logging, but primed to start at a later date and time (delayed start).
-  **Green single flash**  
The data logger is currently logging. No temp. alarm
-  **Green and Orange single flash**  
The data logger is currently logging. Low temperature alarm
-  **Red single flash** The data logger is currently logging. Low temperature alarm.
-  **Red and Orange single flash**  
The data logger is full and has stopped logging. Low temperature alert.
-  **Red double flash** The data logger is currently logging. High temperature alert.
-  **Red and orange double flash**  
The data logger is full and has stopped logging. High temperature alert.
-  **Orange single flash** The battery is running low as its voltage has dropped below 3.3V. Data logging will continue until the battery voltage drops below 2.8V.
-  **No LEDs flash**  
The data logger is stopped, the battery is empty or there is no battery

## REPLACING BATTERY

Your data logger is provided with a 3.6V 1/2AA battery already installed. You can change the battery by following the instructions below.

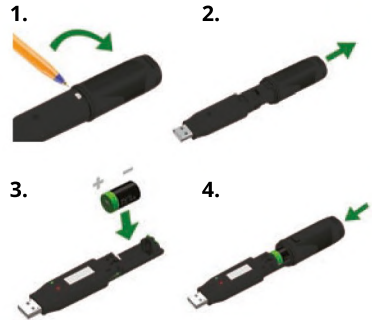

# The Software - Quick Start Guide

## DOWNLOAD AND INSTALL SOFTWARE

Visit [www.lascarelectronics.com/software/easylog-software/easylog-usb/](http://www.lascarelectronics.com/software/easylog-software/easylog-usb/) and click 'Download'



## USING THE SOFTWARE

- Insert the data logger into an available USB port on your PC.
- Double click on the EasyLog USB icon on your Windows™ desktop. This will load the configuration software. Click 'Set up and start the USB data logger' and follow the set-up wizard.
- When setup is complete, the data logger should be removed from the USB port. Do not leave your data logger in the USB port for extended periods as this will cause some of the battery capacity to be lost (with the exception of EL-USB-1-RCG).
- You can also download the data from a logger that has been recording or view previously saved data from the software