

Refrigerated display cases for confectionery industry

Refrigerated display cases are devices that provide optimal storage conditions for confectionery and food products, not only keeping them fresh, but also displaying them brilliantly.

The greatest advantage of the display case is certainly its **elegant and generous display space** and **panoramic windows**, which allow the products placed inside to be attractively presented and allow customers to see them clearly from all sides. Refrigerated display cases can be used in cafés, restaurants, shopping mall traffic halls, banquet halls or retail spaces.

All refrigerated display cases models are available in a version with an **energy-saving inverter compressor, which allows you to save up to 50% of electricity!**

As standard, the devices have **energy-saving LED lighting** and **electronic temperature controller with clear display**.



Model AKM

width	120,5; 140,5; 160,5; 180,5; 200,5; 220,5 cm
depth	74,5 cm
height	199 cm
exposition width	110; 130; 150; 170; 190; 210 cm
exposition depth	62 cm
exposition height	150 cm
height of stools	20; 40; 60 cm
refrigerant (HC)	R-290
rated power	230 V~ / 50 Hz
defrosting	automatic

Attention: after replacing legs for wheels, the height of the device is 204 cm, with a platform 234,5 cm

More information: **+48 790 444 619; +48 790 444 631**
www.rapa.pl/en CONTACT US

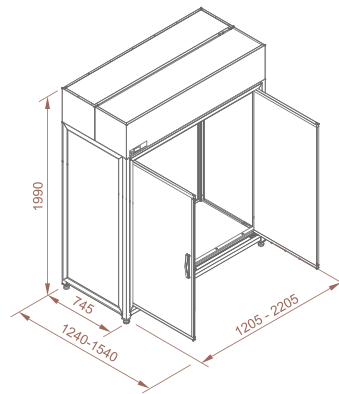

Possibility of **painting the device and shelves in a RAL colour** from the RAPA colour chart or an individual colour chosen by the customer.

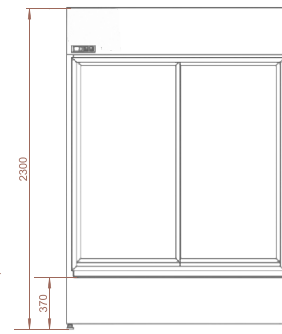

platform

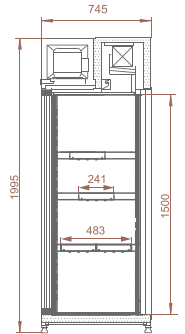

levels of adjustable shelves

It is possible to order a **platform for the refrigerated display case**.

The AKM model can be fitted with **levels of shelves**.

Choice between **sliding or hinged doors**.

Size for every interior

You will gain extra space, because we have prepared a refrigerator in **6 different sizes**.

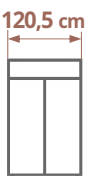
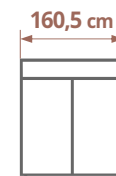
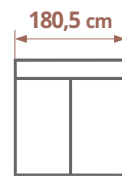
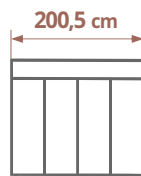
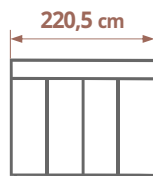

[rapa.pl/en](http://www.rapa.pl/en)

